

## Techtop Industries Nameplate and Performance Data

| NAMEPLATE DATA                             |            |             |
|--|------------|-------------|
|  | 60 Hz.     | 50 Hz.      |
| Horsepower                                 | 75.0       | 75.0        |
| Frame Size                                 | 280M       |             |
| Speed, RPM                                 | 1185       | 980         |
| Voltage                                    | 3 Phase US | 190/380     |
| # Phase                                    | 3          |             |
| Full Load Amps                             | 175.4/87.7 | 208.0/104.0 |
| Power Factor                               | 0.86       | -           |
| Nominal Efficiency                         | 94.5       | -           |
| 3/4 Load Efficiency                        | -          | -           |
| Service Factor                             | 1.15       | 1.0         |
| Duty                                       | Cont. / S1 |             |
| FL Temp Rise °C                            | 72.0       | 95.0        |
| Enclosure                                  | TEFC       |             |
| Ambient Temp °C                            | 40         |             |
| KVA Code                                   | H          | E           |
| FL Amps. @ 208 V                           | -          | -           |
| Insulation Class                           | F          |             |
| NEMA Design                                | -          |             |
| Weight                                     | 1052.0     |             |
| DE Bearing                                 | 6316C3     |             |
| NDE Bearing                                | 6316C3     |             |
| dB No-Load                                 | -          |             |
| Rotor Wk <sup>2</sup> , Lb-Ft <sup>2</sup> | -          |             |
| Start Capacitor                            | -          |             |
| Start Capacitor V                          | -          |             |
| Run Capacitor                              | -          |             |
| Run Capacitor V                            | -          |             |
| Number of Leads                            | 12         |             |
| Connection                                 | ??/?       |             |
| Coil Resistance                            | -          |             |

|              |                            |
|--------------|----------------------------|
| Motor Model: | GR3-CI-TF-280MB3-6-BR-D-75 |
|--------------|----------------------------|

Performance Load Values:

| % Load | Horsepower | Current, Amps | Input power, Kilowatts | Speed, RPM | Efficiency | PF |
|--------|------------|---------------|------------------------|------------|------------|----|
| 0      | -          | -             | -                      | -          | -          | -  |
| 25     | -          | -             | -                      | -          | -          | -  |
| 50     | -          | -             | -                      | -          | -          | -  |
| 75     | -          | -             | -                      | -          | -          | -  |
| 100    | -          | -             | -                      | -          | -          | -  |
| 125    | -          | -             | -                      | -          | -          | -  |
| 150    | -          | -             | -                      | -          | -          | -  |
| SF     | -          | -             | -                      | -          | -          | -  |

|                     | Torque, Lb-Ft | % Full Load Torque | Speed, RPM | Current Amps. |
|---------------------|---------------|--------------------|------------|---------------|
| Locked Rotor Torque | -             | -                  | -          | -             |
| Pull Up Torque      | -             | -                  | -          | -             |
| Breakdown Torque    | -             | -                  | -          | -             |
| Full Load           | -             | -                  | -          | -             |

### Speed Torque Curve

Please contact Techtop for image.

### Dimensional Drawing

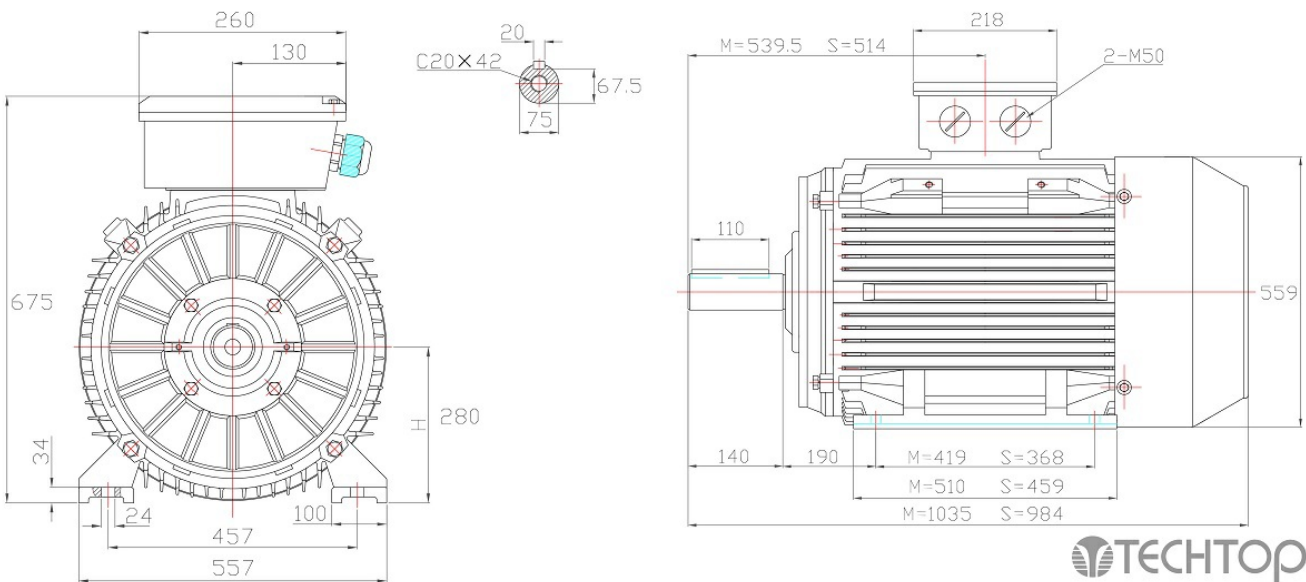

Dimensions are for reference only. Allowance should be made for minor deviations in non standard specified properties.

3D Image Link: Not available for this motor